



The Quartz

House & Land
Block T of AG
South Jerrabomberra



Block Size	477m ²
Living	154m ²
Garage	38m ²
Alfresco	9m ²

Key Features

- 4 Bedrooms
- Double garage
- Walk-in robe
- Walk-in pantry
- Colorbond roof
- Alfresco area (optional)
- Double-glazed windows throughout.

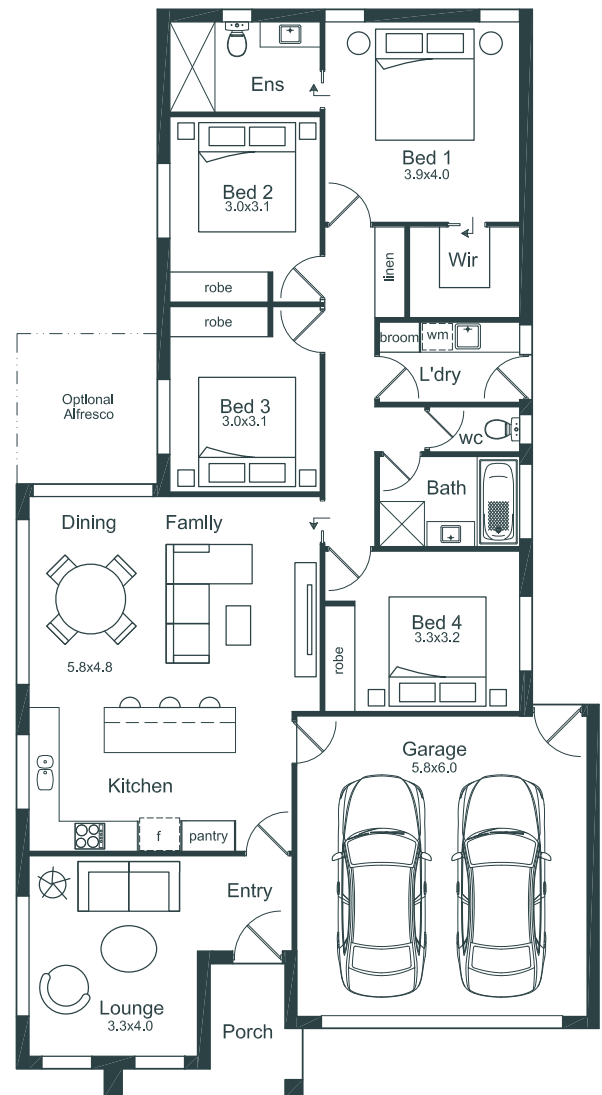

For any enquiries please get in touch with
Steven Pinto (Owner & Builder)
0416 454 555 or steven@metric.homes
www.metric.homes

Disclaimer. Dimensions on this design plan are primarily for marketing purposes.
 Dimensions tend to be approximate and will likely be subject to changes once we engage with you and the architect.

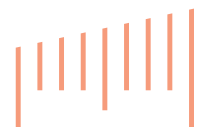

Metric Homes