



# The Kelvin

**House & Land**  
**Block S of AG**  
**South Jerrabomberra**



Block Size	477m <sup>2</sup>
Living	154m <sup>2</sup>
Garage	38m <sup>2</sup>
Alfresco	9m <sup>2</sup>

## Key Features

- 4 Bedrooms
- Double garage
- Walk-in robe
- Walk-in pantry
- Colorbond roof
- Alfresco area (optional)
- Double-glazed windows throughout.

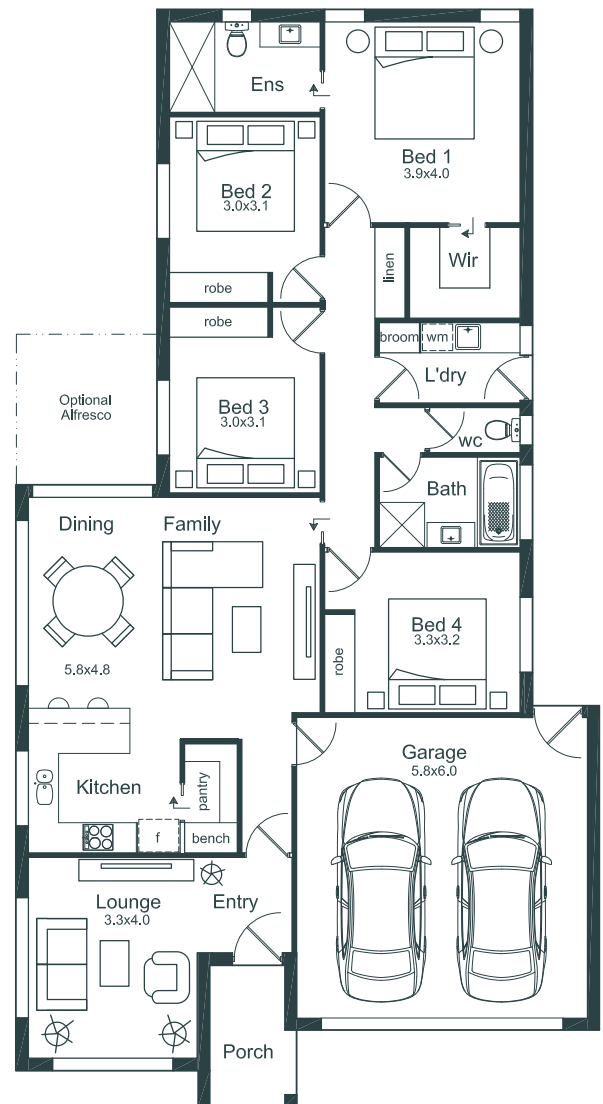

For any enquiries please get in touch with  
**Steven Pinto (Owner & Builder)**  
**0416 454 555 or [steven@metric.homes](mailto:steven@metric.homes)**  
**[www.metric.homes](http://www.metric.homes)**

Disclaimer. Dimensions on this design plan are primarily for marketing purposes.  
 Dimensions tend to be approximate and will likely be subject to changes once we engage with you and the architect.

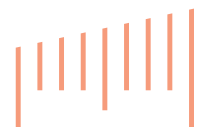

**Metric Homes**